



CHARLES KNIGHT
ESTATE AGENTS



11 Hildenborough Gardens

, Bromley, BR1 4NU

£2,495

Available with Zero Deposit

Nestled in the charming Hildenborough Gardens of Bromley, this delightful three-bedroom offers an excellent opportunity for those seeking a comfortable living space. The property is semi-detached, presenting the potential for home improvements that could add significant value, subject to the necessary planning permissions.

This residence is ideally suited for families and individuals alike, providing a warm and inviting atmosphere. Its spacious layout ensures that you will have ample room to relax and unwind. The location is particularly advantageous, as it is just a short walk from both Sunridge Park and Beckenham Hill Stations, making it a fantastic choice for commuters heading into Central London.

In addition to its excellent transport links, the property is conveniently located a short drive away from Bromley town centre, where you will find a variety of local amenities, shops, and dining options. This combination of accessibility and community makes Hildenborough Gardens a desirable place to call home.

EPC: C
London Borough of Lewisham: Band C - £1,988.74 per Annum

Disclaimer:
Please note that some photographs used in this advertisement may have been digitally enhanced or modified for

Viewing

Please contact our Lewisham Office on 02088 524441 if you wish to arrange a viewing appointment for this property or require further information.

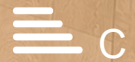

Floor Plan

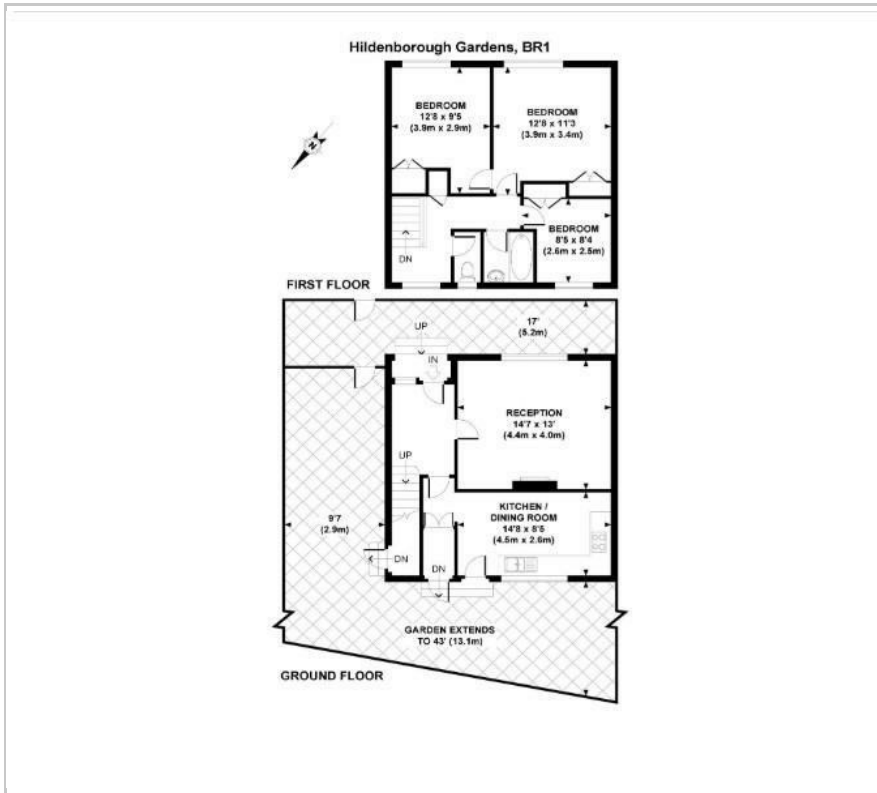

Area Map



Energy Efficiency Graph

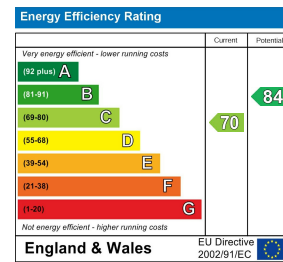

These particulars, whilst believed to be accurate are set out as a general outline only for guidance and do not constitute any part of an offer or contract. Intending purchasers should not rely on them as statements of representation of fact, but must satisfy themselves by inspection or otherwise as to their accuracy. No person in this firm's employment has the authority to make or give any representation or warranty in respect of the property.